



UPIT Automated Smart Tool Management System

POWERTOOLS



优立科智能科技



UPIT aims to assist and provide every user with advance technology to improve manufacturing efficiency so as to save cost resulting an increase in profits through a good resource management process.

Our capabilities include providing a full range of intelligent equipment solutions and data management software for use by the user in the precision manufacturing industry. This will prepare our customer to embrace the new era of industry 4.0 !

Our Service include:

Automated Tool Management System

Customized Electronic Resource Planning Software

Full Range for Real-Time Manufacturing Management Platform

We are a team of talented group of individual who specialize in providing smart devices and software that will suit and meet your requirements



Introduction to UPIT Smart Tool Management System

The UPIT Smart Tool Management system helps to store and retrieve your tools securely and systematically. It comprised of a main smart tool cabinet with a back end software which will be connected through a cloud service. It is able to customized data collected from end user to formulate the best solutions to meet the customer needs with the highest efficiency achieved.

1. Smart Tool Cabinet
2. Cloud Services
3. Back End Customised Software

1

Smart Tool
Cabinet



2

Cloud Services



3

Back end Customized Software



Usage Capabilities



Cutter



Milling Tools



Tap Tools



Drill Chuck



Drill



Grinding Wheel



Shank



General Tools

Product Introduction – Automated Tool Management System Process Flow

• Product introduction



Spare Parts



**Warehouse
Stores**



Product Introduction – Main Cabinet

Product introduction



- *Centralised Tool Storage
- *Smart Inventory Management System
- *32" Touch Screen
- *Real Time Tracking of Tool Withdrawal Quantity and available stock
- *Customized linking to ERP, Cloud Services or End User Server
- *Cabinet Dimension 1065*796*1820 mm

- 70 available storage space is one of the main advantage of the smart tool cabinet.
- It largely increase the efficiency as many types of tools can be managed at the same time.

Product Introduction – User Log In Interface

Product Introduction – User login



The system utilize the end user information to generate a QR code or fingerprint for login



Product Introduction – Withdrawal of Tools

• Product introduction

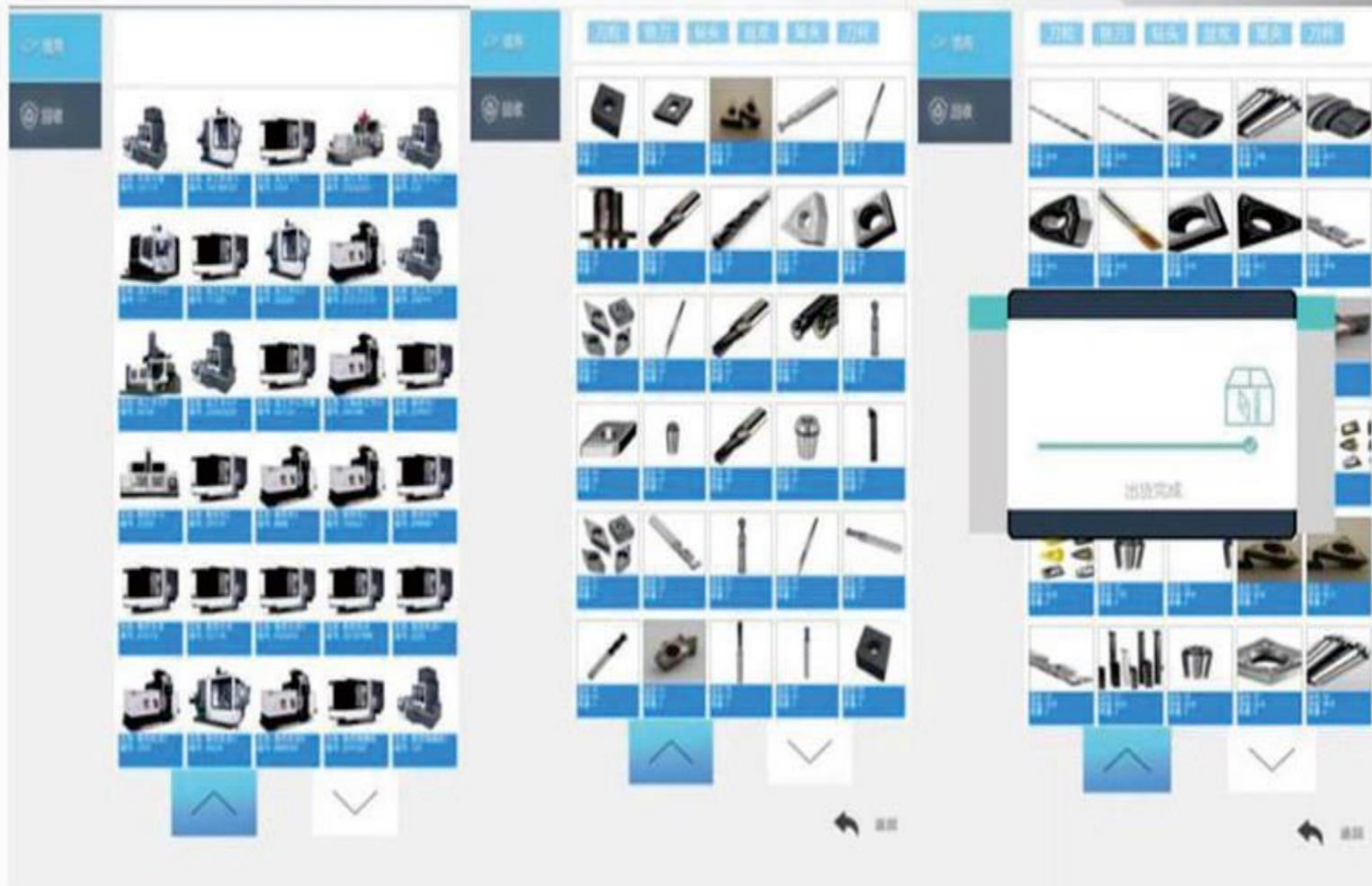

- ✓ Withdrawal can be activated through settings from the system or manually by the user
- ✓ Real time tools withdrawal quantity shown
- ✓ Real time quantity of current stocks available
- ✓ Easy access to list of various tools available for selection
- ✓ Fast and easy retrieval

Product Introduction – Storage Cabinet

• Product introduction

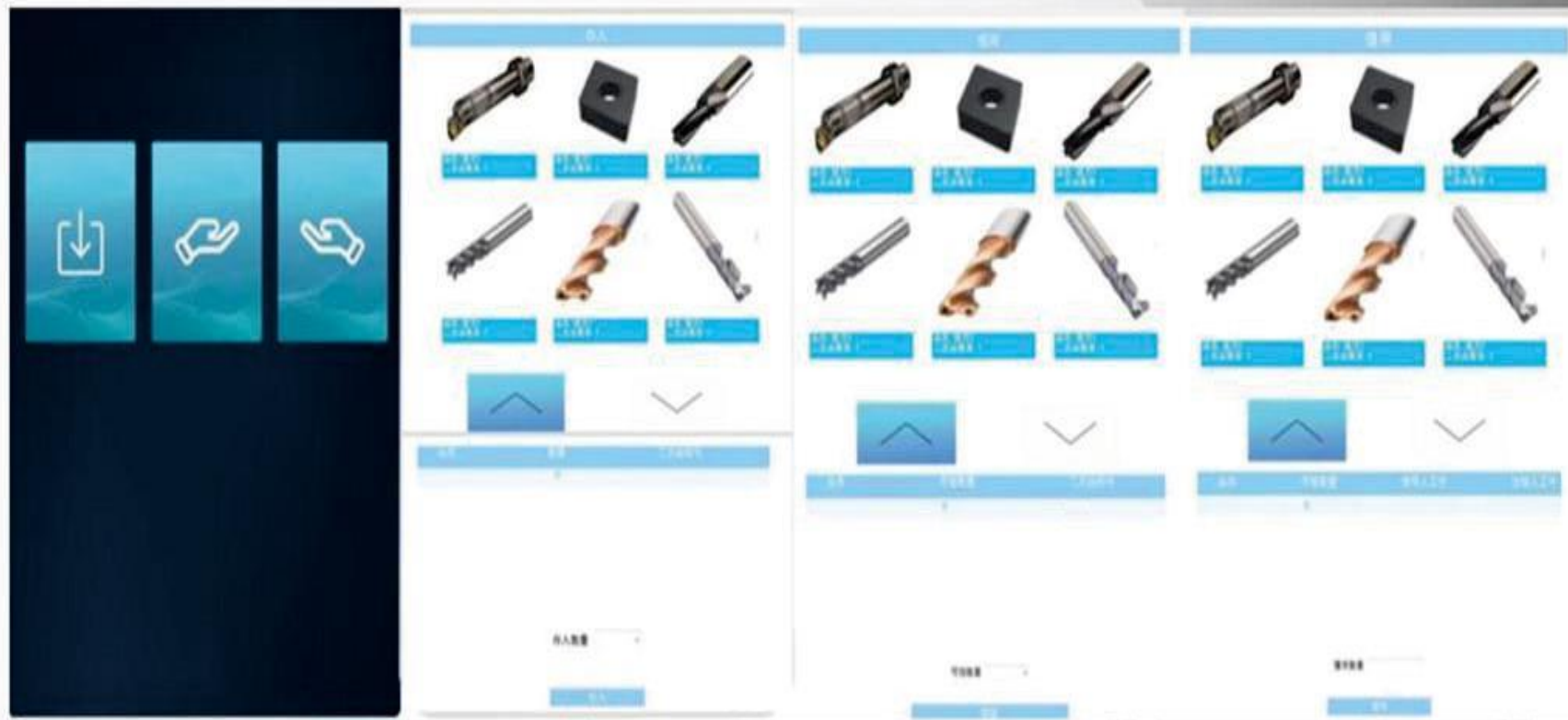

- System is able to store and record used tool.
- Settings can be done to prioritise to select to use the used tool over the new tool set first.
- Storage, withdrawal, loaning of tool will be done through the system and recorded for future references in a systematically manner.

Product Introduction – User Settings

• Product introduction



用户ID	姓名	电话	登录名	密码	状态
1	张三	13800138000	zhangsan	123456	正常
2	李四	13900139000	lisi	654321	正常
3	王五	13700137000	wangwu	111111	正常
4	赵六	13600136000	zhaoliu	222222	正常
5	孙七	13500135000	sunqi	333333	正常
6	周八	13400134000	zhouba	444444	正常
7	吴九	13300133000	wujiu	555555	正常
8	郑十	13200132000	zhengshi	666666	正常
9	陈十一	13100131000	chen11	777777	正常
10	冯十二	13000130000	feng12	888888	正常

- Able to add user accessibility to the system or remove user excess rights
- Set and customize access rights to individual users
- Login done with Wechat ID with personalize account or password
- Record user information
- Set alert system for storage

Product Introduction – Storage of Tools

- Product introduction

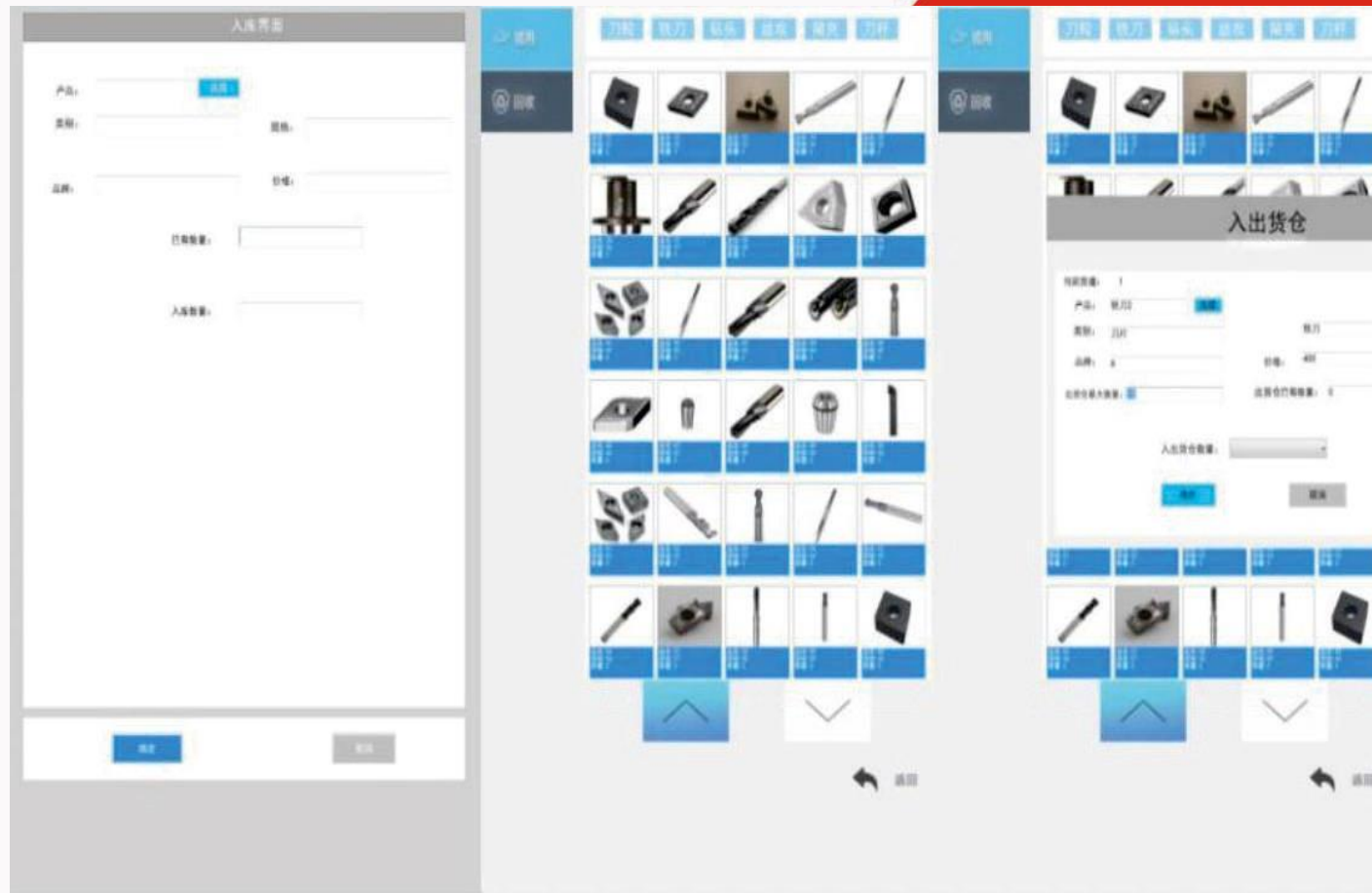

- Able to handle and store a huge variety of tools
- No worries of storage space
- User friendly system
- List of tools display with photograph to easy identification

Product Introduction – Usage Report

Product introduction

The image displays six screenshots of a software application interface, likely for inventory management. Each screenshot shows a different report or data view:

- Withdrawal List (损耗列表):** A table showing withdrawal records with columns for date, item name, quantity, and status.
- Personal Report (个人报表):** A summary report for a specific user, showing their withdrawal and inventory data.
- Withdrawal Detail (回收明细表):** A detailed view of withdrawal records, including item names, quantities, and dates.
- Summary (总报表):** A comprehensive overview of all data, including withdrawal and inventory information.
- Inventory (库存报表):** A report showing current inventory levels for various items.
- Usage Detail (领用明细表):** A detailed view of usage records, showing item names, quantities, and dates.

Usage report will includes information on past records of tools withdrew and retrieved, storage capacity, low inventory etc.

Current Problem Faced

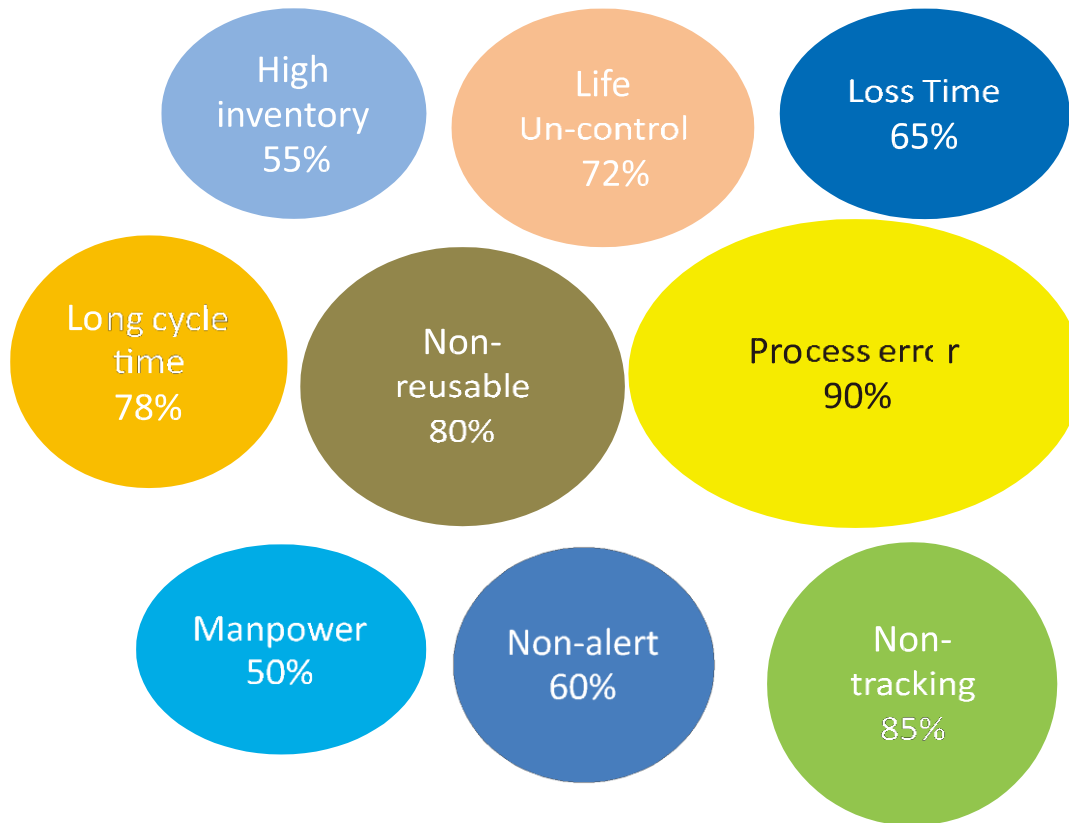

What are the current problem faced by most Companies?

- Missing or lost tools
- Unable to control tool life
- Unable to keep track of expenditure on tool
- Too much time spend on stock taking for tooling
- Over purchase of the same tool
- Too much of excess quantity of unused tool
- Too much time spend to retrieve and record tool
- Unable to keep track of low inventory resulting in sudden lack of tool required
- High overheads spent to maintain all the tools

Solution to the problem – Automated Smart Tool Management System

- ✓ Accurately provide cost of tooling spent with readily available helpdesk
- ✓ Real time review of tool condition and quantity with retrieval and storage all done automatically through a well managed system
- ✓ Customized rights for individual for withdrawal of controlled tool for better control and security
- ✓ Automatic alert system for low inventory or any other abnormalities
- ✓ Customize and restrict tool quantity for each withdrawal
- ✓ No more queue for withdrawal of tools, increase productivity and efficiency
- ✓ Loss of tools can be easily tracked through usage record by the last user for liability
- ✓ Ability to centralize tooling management with robust management system

Plan

Alert



Verification

Selection

Delivery

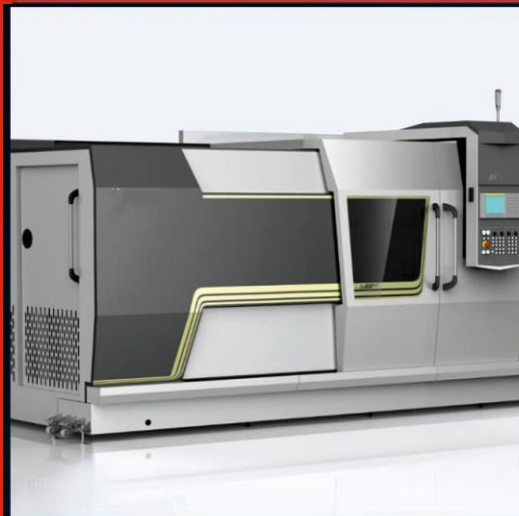

second-hand
product



SET



OUTUSE



RECYCLE



QUQEY

Product Advantage

- ✓ 32 inch touch screen system for easy assess
- ✓ Optimize tooling life, less wastage, environment friendly
- ✓ Provide a clear list of tool available for easy accessibility
- ✓ Expandable with additional storage
- ✓ Back up data in case of power failure
- ✓ Clean and neat operating platform for easy usage without any fuss
- ✓ Detailed and informative report for great overview of real time situation
- ✓ Storage alert for low inventory to prevent running out of stock
- ✓ Support enterprise development and helps to enhance and simplify tooling management



We reserve the right to modify the design and specifications without prior notice. Above specifications are for reference only. Correct specifications are based on actual machine due to constant upgrade and improvement on the product.



优立科智能科技

China Add : No. 225 Huajin Road, Tongan Town, Suzhou Jiangsu P.R. China 215153 Tel : 13601540707 www.upitpl.com

OUR DISTRIBUTOR



POWERTOOLS SINGAPORE PTE LTD

7 Yishun Industrial Street 1 #03-43 NorthSpring Bizhub Singapore 768162
Tel: 65-6570 1172 Fax: 65-6570 1182 Email: sales@powertools.com.sg
www.powertools.com.sg Co. Reg. No. 201007910C GST Reg. No.: 201007910C